

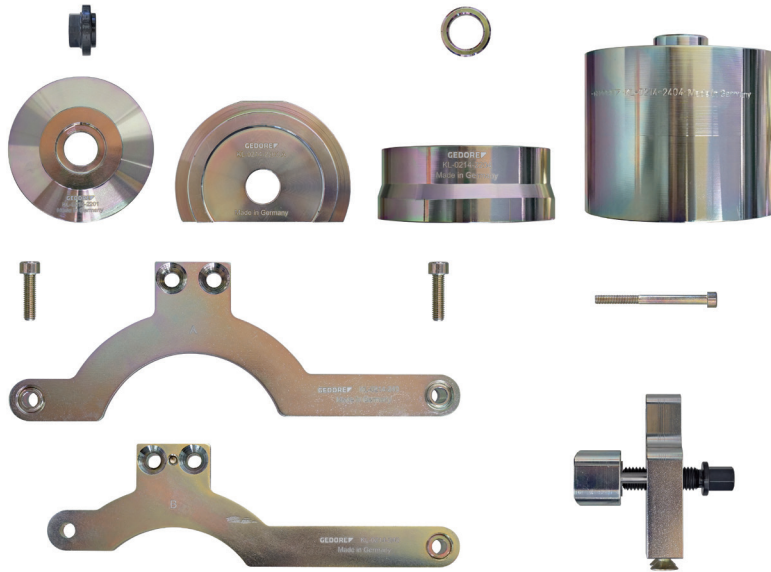

# KL-0214-240 / KL-0214-241

## Double silent block tool VW



**Operating instructions** EN  
 ⚠ Read and understand before use!

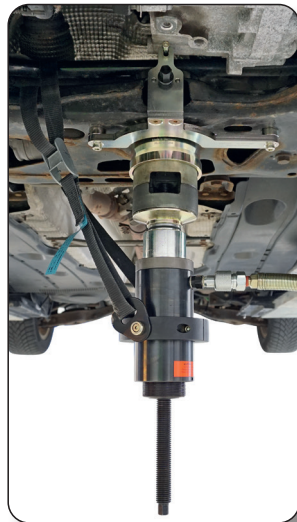

[www.gedore-automotive.com](http://www.gedore-automotive.com)



**GEDORE Automotive GmbH**

Breslauer Straße 41  
78166 - Donaueschingen  
Postfach 1329  
78154 Donaueschingen - GERMANY

☎ +49 (0) 771 / 8 32 23-0  
☎ +49 (0) 771 / 8 32 23-90  
✉ info.gam@gedore.com  
🌐 gedore-automotive.com

**GEDORE TOOLS, INC.**

Only for USA, Canada & Mexico / Sólo para EE.UU., Canadá y México  
Seulement pour les USA, le Canada et le Mexique  
7187 Bryhawke Circle, Suite 700  
North Charleston, SC 29418, USA

☎ +1-843 / 225 50 15  
☎ +1-843 / 225 50 20  
✉ info@gedoretools.com  
🌐 gedore.com

Version 2- 02/2021



ENGLISH

EN

## Manufacturer's address

GEDORE Automotive GmbH

Breslauer Straße 41 // 78166 Donaueschingen - GERMANY

☎ +49 (0)771/83223-71 // ✉ info.gam@gedore.com

## Imprint

In the course of improvement and adaptation to the state of the art, we reserve the right to make changes with regard to appearance, dimensions, weights and properties, and performance.

This does not imply any claim to correction or subsequent delivery of already delivered products. Deletions can be made at any time without any legal claim arising.

Instructions for use and safety are not binding. They never substitute for any legal or trade association regulations.

We do not accept any liability for printing errors.

Any reproduction, in whole or in part, requires the prior written consent of **GEDORE Automotive GmbH**.

All rights reserved worldwide. © Copyright by **GEDORE Automotive GmbH**, Donaueschingen (GERMANY)

We refer to our general terms and conditions which  
can be found in the imprint at:

[www.gedore-automotive.com](http://www.gedore-automotive.com)



## Contents

<b>1. Basic safety instructions</b> .....	<b>4</b>
1.1 Target group .....	4
1.2 Intended use .....	4
1.3 Misuse/abuse.....	4
1.4 Personal protective equipment.....	4
1.5 Handling .....	4
1.6 Basic warnings .....	5
1.7 Work environment .....	5
1.8 Emissions .....	5
1.9 Malfunctions.....	5
<b>2. Product description</b> .....	<b>6</b>
2.1 KL-0214-240 - Double silent block tool VW .....	6
2.2 Scope of delivery.....	6
2.3 Specifications.....	6
<b>3. Preparations</b> .....	<b>7</b>
3.1 Checking the scope of delivery.....	7
3.2 Necessary drive .....	7
3.3 Preparing the tool .....	7
3.4 Preparing the vehicle .....	7
<b>4. Typical application</b> .....	<b>8</b>
4.1 Removal of double silent blocks .....	8
4.2 Assembly of the preloading device .....	10
4.3 Installation of double silent blocks .....	11
<b>5. Care and storage</b> .....	<b>13</b>
<b>6. Maintenance and repair by the GEDORE Automotive Service Center</b> .....	<b>14</b>
<b>7. Supplementary kit</b> .....	<b>14</b>
<b>8. Environmentally friendly disposal</b> .....	<b>14</b>

EN

## 1. Basic safety instructions

### ⚠ WARNING

Read and understand the operating instructions before you start using the double silent block tool. Misuse can result in **severe or fatal injuries**.

The operating instructions are part of the double silent block tool. Keep these operating instructions at a safe place for future reference, and always pass them on to subsequent users of the double silent block tool.

### 1.1 Target group

These operating instructions are intended for skilled personnel in motor vehicle workshops.

**Never** allow unauthorised persons or minors to use the double silent block tool.

The purchaser of the boring tool for clamping screws **must** ensure that the user has read and understood the operating instructions completely before he uses the double silent block tool.

The operating instructions **must** be available at all times to the user of the double silent block tool.

### 1.2 Intended use

The double silent block tool is **only** used for the removal and installation of double silent blocks (silent blocks of the torque support) on unit carriers made of bent steel parts.

The double silent block tool may only be used by skilled personnel in motor vehicle workshops.

The double silent block tool **may only be used** in the way that is described in the operating instructions.

The double silent block tool **may only** be actuated with suitable drive components and/or a hydraulic cylinder/pump combination which ensures safe operation!

- Any other use can result in **severe or fatal injuries**.

### 1.3 Misuse/abuse

**Never** subject the double silent block tool to technical modifications or additions or conversions that could have even the slightest effect on safety.

The double silent block tool **must never** be operated with impermissible and risky drive components.

- **Always** read and observe **all** warnings, safety instructions and other instructions for the operation and maintenance of the double silent block tool.
- The double silent block tool **may only** be used in a way as described in **Chapter 1.2 - Intended use**. Any other use can result in **death** or **severe injuries!**

### 1.4 Personal protective equipment

**Always** wear your personal protective equipment when you use the double silent block tool. The double silent block tool can bring about mechanical hazards, such as crushing, cutting and shock injuries.



**EYE PROTECTORS must** (see OSHA 29 CFR 1910.133 and ANSI Z87) be worn when using the double silent block tool, to protect against flying objects.

- Particles can be ejected when working with the double silent block tool, and cause severe injuries to your eyes.



**PROTECTIVE GLOVES must** be worn when using the double silent block tool.

- Working with the double silent block tool can cause skin abrasions and crushing.



**SAFETY SHOES** with anti-slip sole and steel toe cap (see OSHA 29 CFR 1910.136 and ANSI Z41) **must** be worn when using the double silent block tool.

- Dropping parts can cause injuries to feet and toes.

### 1.5 Handling



#### ⚠ CAUTION

Observe the following safety precautions to avoid injuries and material damage as a result of misuse and unsafe handling of the double silent block tool. **Misuse can result in severe or fatal injuries.**

- Before using the double silent block tool, it is **essential** to observe the **Basic warnings** given in **Chapter 1.6!**
- The double silent block tool must be checked for perfect condition **before each use**, and defective or worn parts **must** be replaced before use!
- Use only genuine **GEDORE Automotive** spare parts and accessories for the double silent block tool.

## 1.6 Basic warnings

For better differentiation, warnings in these operating instructions are classified as follows:

Warning sign	Signal word	Meaning
	<b>WARNING</b>	Indicates a hazardous situation which, if not avoided, could cause <b>severe or even fatal injuries</b> .
	<b>CAUTION</b>	Indicates a hazardous situation which, if not avoided, could cause <b>medium or light injuries</b> .
	<b>ATTENTION</b>	Indicates a situation which, if not avoided, can cause damage to the tool, its functions, or an object in its vicinity.
	<b>Note / tip</b>	<b>Note</b> on important information and useful tips for use.

### **WARNING**

Using unsuitable driving components can cause **severe or fatal injuries**.

- The double silent block tool may only be actuated with suitable drive components and/or a hydraulic cylinder/pump combination which ensures safe operation!
- The double silent block tool must **never** be driven with an impact screwdriver!

When removing and installing double silent bearings, there is a risk that the draw spindle on the double silent block tool can break and, consequently, parts flying about. This can result in **severe or fatal injuries**.

- Never exceed the maximum load capacity of the draw spindle of **7t**!
- Before every use, make a visual check if the double silent block tool is damaged.
- Never use the double silent block tool if it shows any damage or other abnormalities.
- Ensure that work on vehicles is carried out always in compliance with the instructions and safety regulations of the vehicle manufacturer.
- Wear personal protective equipment (*safety goggles, protective gloves, safety shoes*).
- Use **only genuine GEDORE Automotive** spare parts and accessories.
- Do not stand in the axial extension of the double silent block tool!

### **CAUTION**

During transport, preparation, and operation of the double silent block tool, various parts can fall down and lead to **moderate or minor injuries**.

- The workplace for the double silent block tool must be sufficiently large and secured against falling.

### **CAUTION**

The double silent block tool and the vehicle could be damaged.

- Lubricate the draw spindle **exclusively** with molybdenum disulphide paste when using the double silent block tool such as, for example, **KL-0014-0030** (*accessory / see catalogue*).
- Only the data and instructions issued by the vehicle manufacturer apply for any work on the vehicle.

## 1.7 Work environment

Safe work with the double silent block tool is only possible when the working environment is safe.

- The workplace **must** be clean and tidy.
- The workplace **must** be sufficiently large and protected.
- The workplace **must** be on a solid non-skidding floor.

## 1.8 Emissions

Molybdenum disulphide paste and hydraulic oil can drip and/or leak when using the double silent block tool and thus pose a hazard to the environment.

- Collect escaping hazardous substances immediately in a suitable container and/or remove it with a cleaning cloth or binding agent, and dispose of in an environmentally friendly manner.

## 1.9 Malfunctions

Maintenance and repair work on the double silent block tool may only be carried out when the system is depressurised.

**Type of the malfunction:** Hydraulic oil can escape at the coupling of the hydraulic cylinder.

**Measure:** If necessary, clean the hydraulic coupling, retighten and/or engage it correctly.

## 2. Product description

### 2.1 KL-0214-240 - Double silent block tool VW

Suitable for double silent blocks on carriers made of steel bent components. Installed e.g. in VW Golf 7 (AU), Golf Sportsvan (AM, AN), Caddy (2K), Tiguan (AD), Touran (5T); Seat Ateca (KH), Leon (5F); Škoda Karoq (NU), Octavia (5E), Superb (3T).

The double silent block tool enables the quick and professional removal and installation of the double silent blocks (silent blocks of the torque arm) directly on the vehicle. It is not necessary to loosen or remove the unit carrier or to carry out a subsequent wheel alignment.\*

**\*Note:** Due to the confined space conditions, the carrier must be lowered and corresponding parts loosened on vehicles with all-wheel drive!

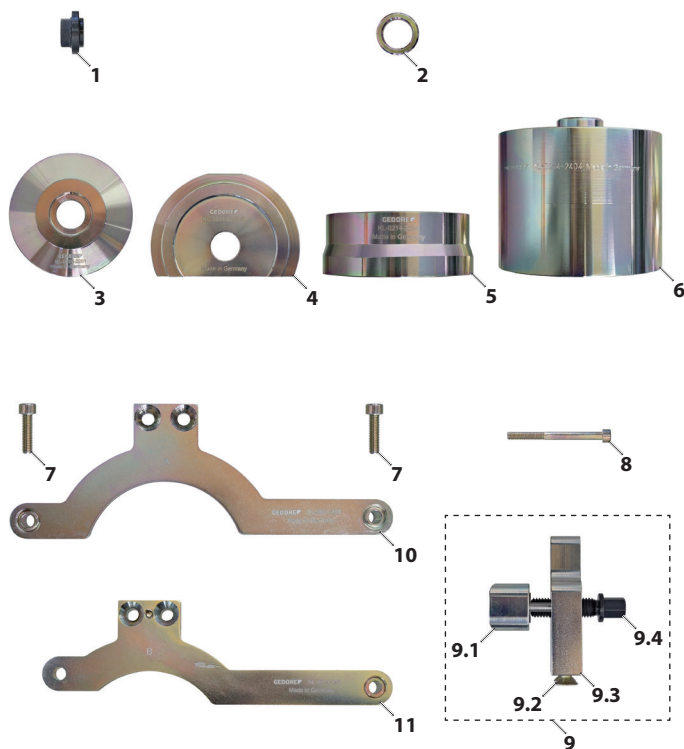

### 2.2 Scope of delivery/spare parts:

Item	Part no.	Description	Quantity
1	KL-0039-1912-3	Hex collar nut M12 flat	1
2	KL-0214-2202	Spacer ring diameter 30mm	1
3	KL-0214-2201	Thrust piece diameter 89.5mm	1
4	KL-0214-2203 A	Position plate	1
5	KL-0214-2204	Conical sleeve diameter 90mm	1
6	KL-0214-2404	Support sleeve diameter 98mm	1
7	KL-1283-1016	Cheese-head screw M8 x 30mm	2
8	KL-0041-7306	Cheese-head screw M6 x 70mm	1
9	KL-0214-2401	Preloading device	1
9.1	KL-0214-2401-2	Clamping shell	1
9.2	KL-5501-1432	Countersunk screw M8 x 25	2
9.3	KL-0214-2401-1	Spindle block	1
9.4	KL-0214-2401-3	Spindle	1
-	KL-0214-2401-4	Axial disc	1
-	KL-0270-3101-2	Grub screw M4 x 8	1
-	KL-0214-2401-5	Dowel pin 6 dia.x60	2
10	KL-0214-2402	Preloading plate A	1
11	KL-0214-2403	Preloading plate B	1

#### Necessary drive



### 2.3 Specifications:

Max. load: ..... 7t

**Fig. 1: Necessary drive**

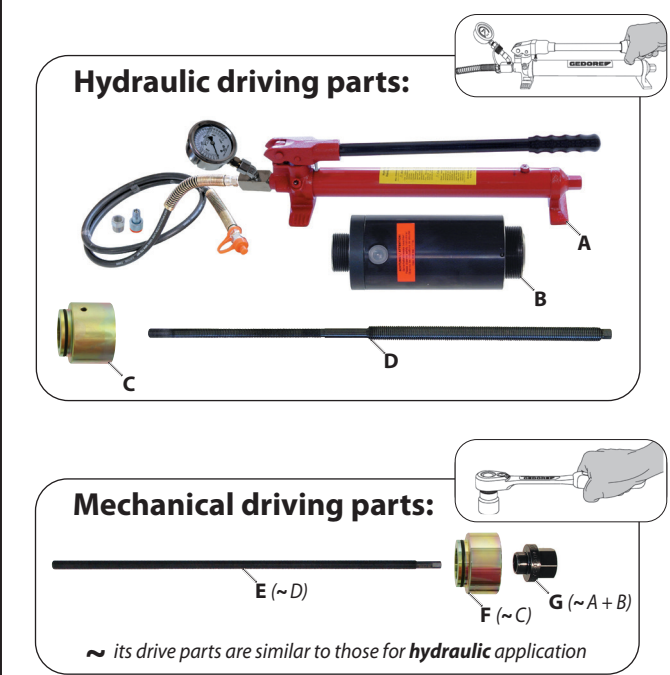

**Fig. 2: Preparing the double silent block tool (hydraulic)**

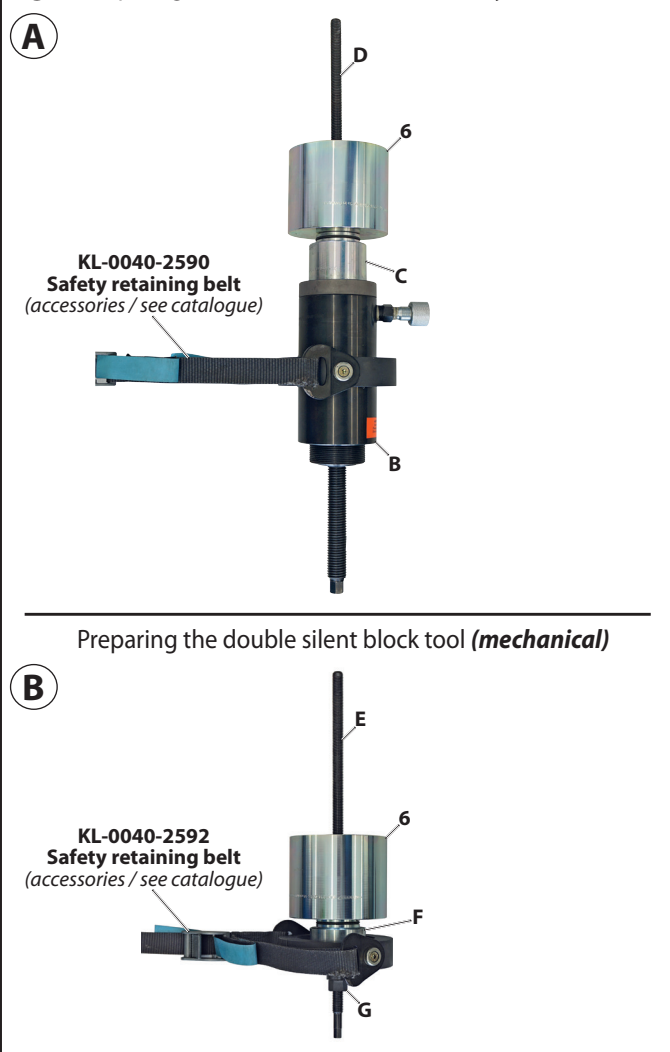

## 3. Preparations

Prior to using the product for the first time, check and ensure that all parts of the scope of delivery are available. Follow the instructions below.

### 3.1 Checking the scope of delivery

### 3.2 Necessary drive

#### ⚠ WARNING

Using unsuitable driving components can cause **severe or fatal injuries**.

- The double silent block tool **may only** be actuated with suitable drive components and/or hydraulic cylinder/pump combinations which ensure safe operation!

- Use **only** genuine **GEDORE** Automotive accessories.

#### Hydraulic driving parts: (see Fig. 1)

Item	Part no.	Description
A	KL-0215-35 M25	Hydraulic pump with 17t manometer
B	KL-0040-2500	Hydraulic cylinder 17t
C	KL-0039-1003	Mounting adapter for hydraulic cylinder
D	KL-0039-1912-1	Draw spindle M12

#### Mechanical driving parts: (see Fig. 1)

Item	Part no.	Description
E	KL-0039-2012-1	Draw spindle M12
F	KL-0039-1011	Mounting adapter for mechanical spindle
G	KL-0039-1912-2	Collar nut M12

**Note:** The typical application **Chapter 4.** is basically described for the **hydraulic** way, the **mechanical** way follows the same principle but with **mechanical** drive parts.

### 3.3 Preparing the tool.

Prepare the double silent block tool according to the type of drive as shown in **Fig. 2A + B**.

**Note:** The safety retaining belt **KL-0040-2590** or **KL-0040-2592**, which is available as an *accessory* (*accessory, see catalogue*) allows the double silent block tool to be secured to the vehicle, thus preventing it from dropping.

### 3.4 Preparing the vehicle

Loosen or dismantle all necessary parts according to the manufacturer's instructions (e.g. dismantle torque arm, loosen bearing on stabiliser and push it upwards with plastic wedges).

**Fig. 3:** Mount thrust piece "3", insert draw spindle "D" and screw on collar nut "1".

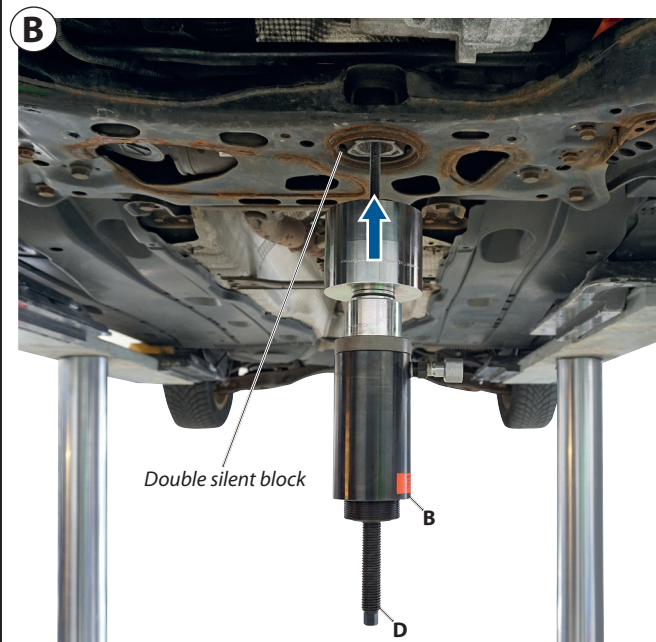
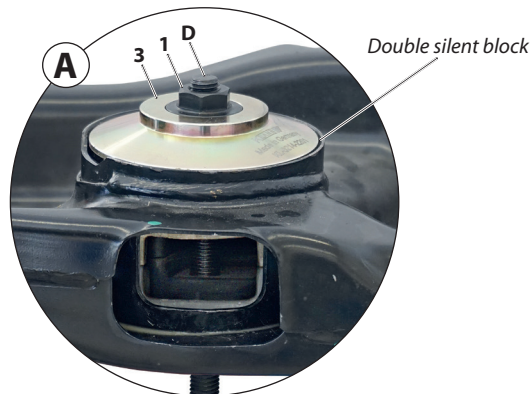

**Fig. 4:** Turn in draw spindle "D" until the support sleeve "6" is applied, secure the double silent block tool.

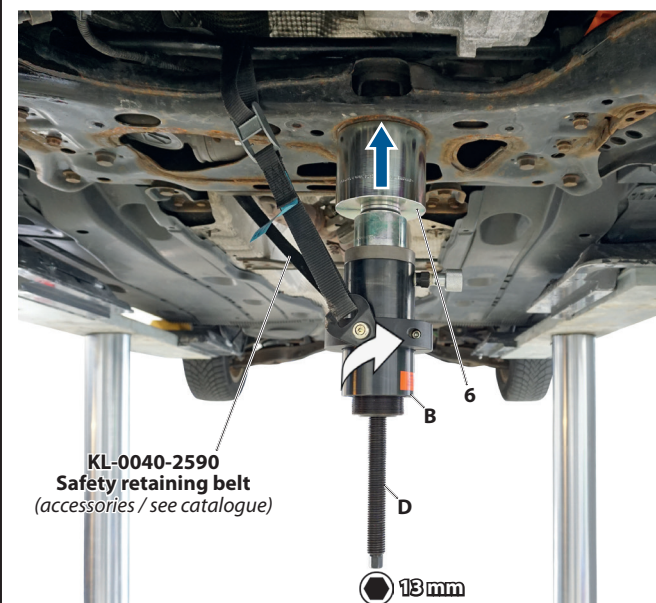

## 4. Typical application

This typical application describes the **hydraulic** removal and installation of a double silent block (silent block of the torque arm) directly on the vehicle, on unit carriers made of bent steel parts.

It is not necessary to loosen or remove the unit carrier or to carry out a subsequent wheel alignment.\*

### \*Note:

Due to the confined space conditions, the unit carrier must be lowered and corresponding parts loosened on vehicles with all-wheel drive!

(The **mechanical** removal and installation follows the same principle.)

### 4.1 Removal of double silent blocks

1. Place thrust piece "3" in the correct position, as shown in **Fig. 3 A**, on the top of the unit support onto the double silent block.

Then insert the pulling spindle "D" with hydraulic cylinder "B" from below through the double silent block (**Fig. 3 B**) until the collar nut "1" can be screwed on clockwise at the top. (**Fig. 3 A**)

### ⓘ Note:

Screw on the collar nut "1" until the draw spindle "D" protrudes slightly at the top.

### ⚠ WARNING

The collar nut "1" may loosen, causing the double silent block tool to fall, this may result in **death** or **serious injury**.

• Counteract the draw spindle "D" when screwing on the hydraulic cylinder "B".

2. Screw the hydraulic cylinder "B" clockwise around the traction spindle "D" until the support sleeve "6" rests properly against the unit carrier. (**Fig. 4**)

### ⓘ Note:

Counteract the draw spindle "D" via the hexagon **spanner** size 13 mm.

### ⚠ WARNING

The double silent block tool may fall when removing the double silent block; this may result in **death** or **serious injury**.

• Secure the double silent block tool against falling, for example with the safety retaining belt **KL-0040-2590** or **KL-0040-2592** (accessories see catalogue)

3. Secure the double silent block tool against falling, fasten the safety retaining belt - **KL-0040-2590** or **KL-0040-2592** to the unit carrier for this. (**Fig. 4**)



**Fig. 5:** Removing the double silent block.

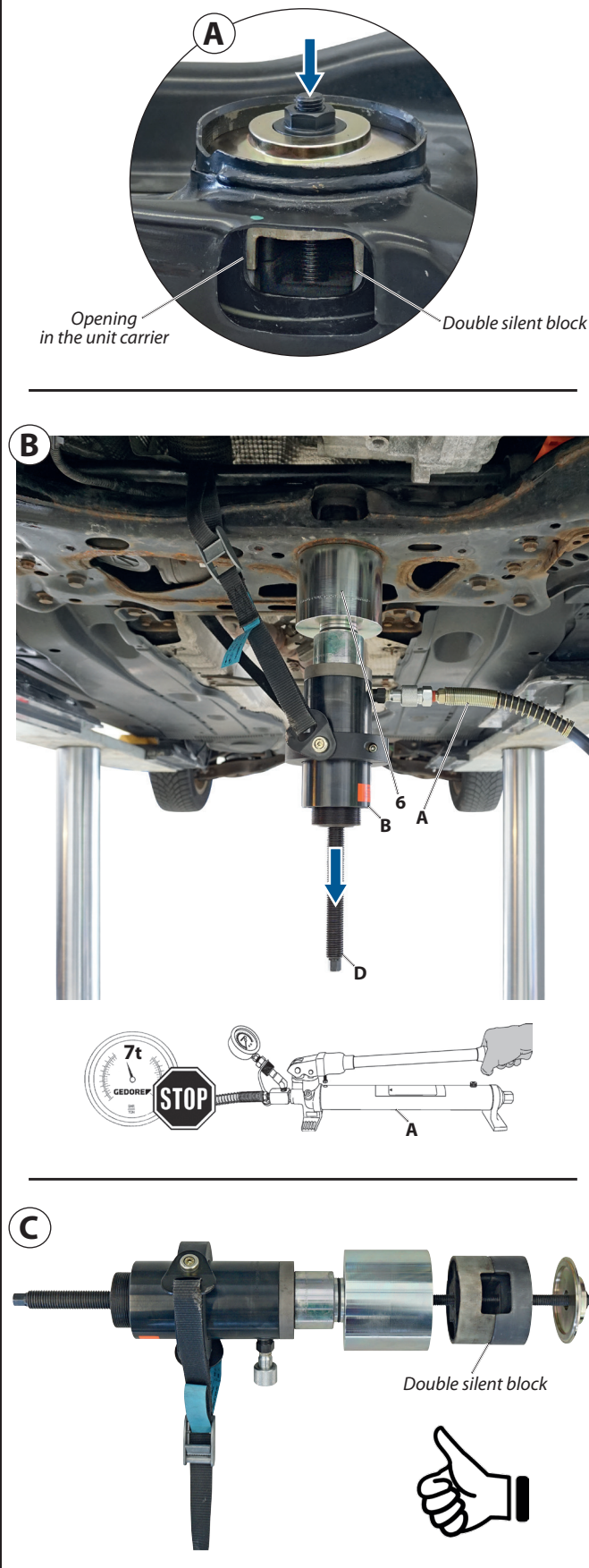

**⚠ WARNING**

Using unsuitable driving components can cause **severe or fatal injuries**.

- The double silent block tool **may only** be actuated with suitable drive components and/or hydraulic cylinder/pump combinations which ensure safe operation!
- Use **only** genuine **GEDORE** Automotive accessories.

4. Connect hydraulic pump "A" to hydraulic cylinder "B".  
(Fig. 5 B)

**⚠ WARNING**

During the removal of double silent blocks, there is a risk of the draw spindle "D" breaking and parts flying about. This can result in **severe or fatal injuries**.

- Do not exceed the maximum loading capacity of **7t** of the draw spindle "D"!

During the installation procedure, watch the required force on the pressure gauge of hydraulic pump "A"!

- Wear personal protective equipment (safety goggles, protective gloves, safety shoes).
- Never stand in the axial extension of the draw spindle "D".

**CAUTION**

During the removal, the double silent block can get caught on the side of the opening in the unit carrier.

- During the removal, watch the double silent block at the side of the opening in the unit carrier and, if necessary, push it softly inwards, for example with the help of a chisel.

(Fig. 5 A)

5. Operate the hydraulic pump "A" and remove the double silent block from the unit carrier. (Fig. 5 B + C)

**ⓘ Note:**

The maximum stroke of the hydraulic cylinder "B" is 45 mm! As soon as a high pressure builds up at the hydraulic pump "A": Interrupt the removal procedure. Release pressure at the hydraulic pump "A", screw in the draw spindle "D" until the support sleeve "6" is fully in contact with the unit carrier again. Continue the removal procedure.



**Expert's tip:**

If the double silent block is very tight, it is advisable to heat it with a hot air blower.

6. Dismantle the double silent block tool, uncouple the hydraulic pump "A" from hydraulic cylinder "B" and continue with **chapter 4.2**.

**Fig. 6:** According to the hole distance on the unit carrier, mount the appropriate preloading plate "10" or "11".

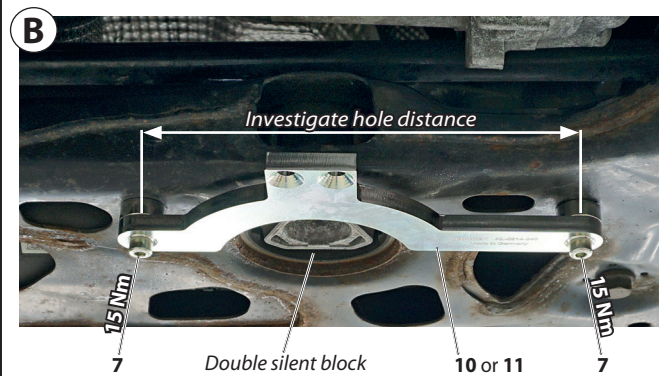
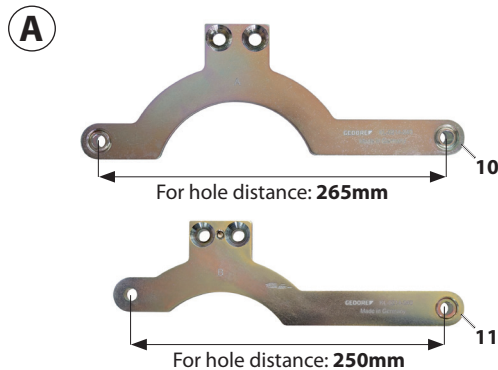

**Fig. 7:** Installing the preloading device "9".

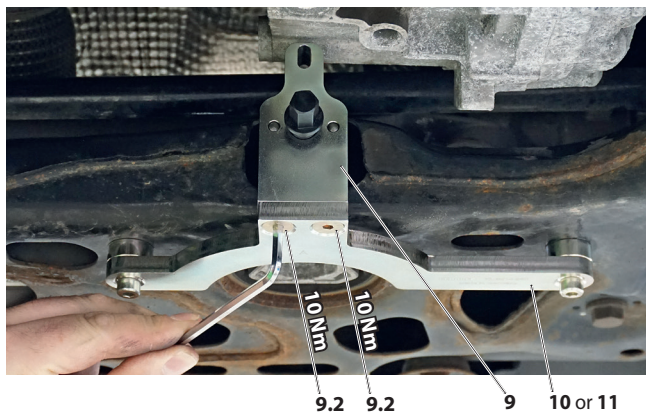

**Fig. 8:** Position the preloading device "9" flush.

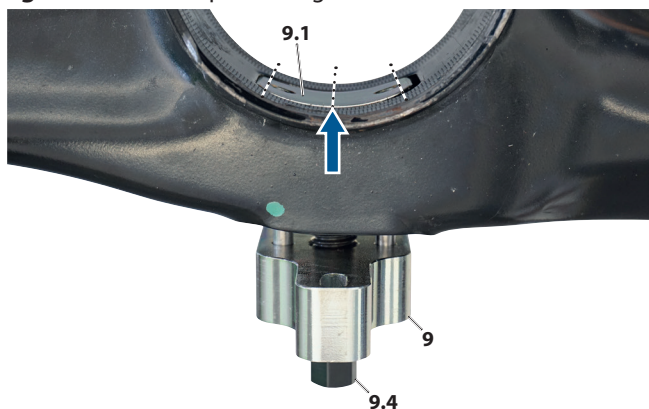

## 4.2 Installing the preloading device

### CAUTION

*Risk of damaging the unit carrier and the double silent block.*

• To prevent damage to the unit carrier and the double silent block, the preloading device "9" must be mounted and positioned before the installation.

1. Investigate the hole distance between the threaded holes on the unit carrier (on the right and left of the double silent block). (**Fig. 6 B**)

According to the hole distance on the unit carrier, mount the appropriate preloading plate "10" or "11". (**Fig. 6 A**)

Hole distance: **265 mm** = preloading plate "10"

**250 mm** = preloading plate "11"

2. Fasten the required preloading plate "10" or "11" in the correct position with the labelling facing downwards to the unit support using the cap screws "7", as shown in **Fig. 6 B**.

### **i**Note:

Tighten the cap screws "7" (**width 6 mm**) with **15 Nm**.

3. Fix the preloading device "9" to the preloading plate "10" or "11" using the countersunk screws "9.2", as shown in **Fig. 7**.

### **i**Note:

Tighten the cap screws "9.2" (**width 6 mm**) with **10 Nm**.

### CAUTION

*Risk of damaging the unit carrier and the double silent block.*

• To prevent damage to the unit carrier and the double silent block, the preloading device "9" must be mounted and positioned before the installation.

4. Position the preloading device "9" by turning the spindle "9.4" clockwise until the clamping shell "9.1" is flush with the **inner diameter** of the double silent block bore. (**Fig. 8**)

**Fig. 9:** Preparation of the double silent block tool.

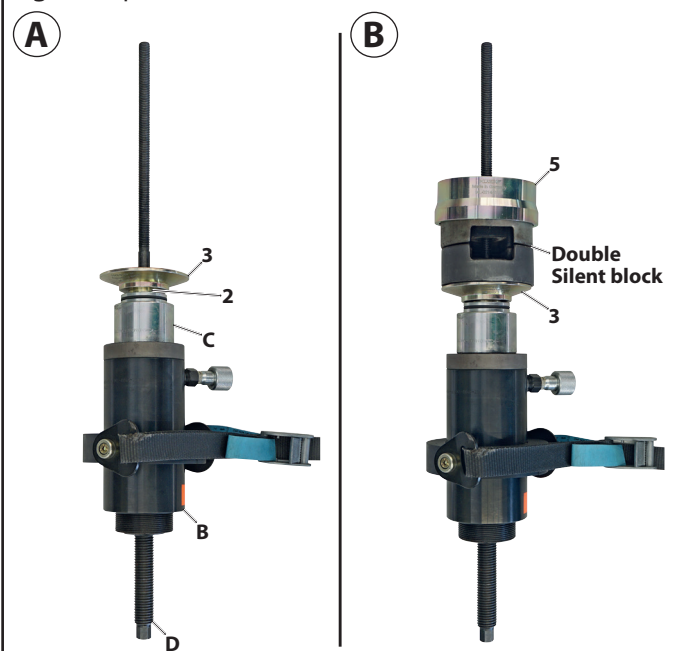

### 4.3 Installation of double silent blocks

1. Fit spacer ring "2" with thrust piece "3" in the correct position on the mounting adapter "C" as shown in **Fig. 9 A**. Afterwards, place the double silent block according to the manufacturer's specifications together with the conical sleeve "5" on the draw spindle "D" as shown in **Fig. 9 B**.

**Fig. 10:** Mount thrust piece "4", insert draw spindle "D" and screw on collar nut "1".

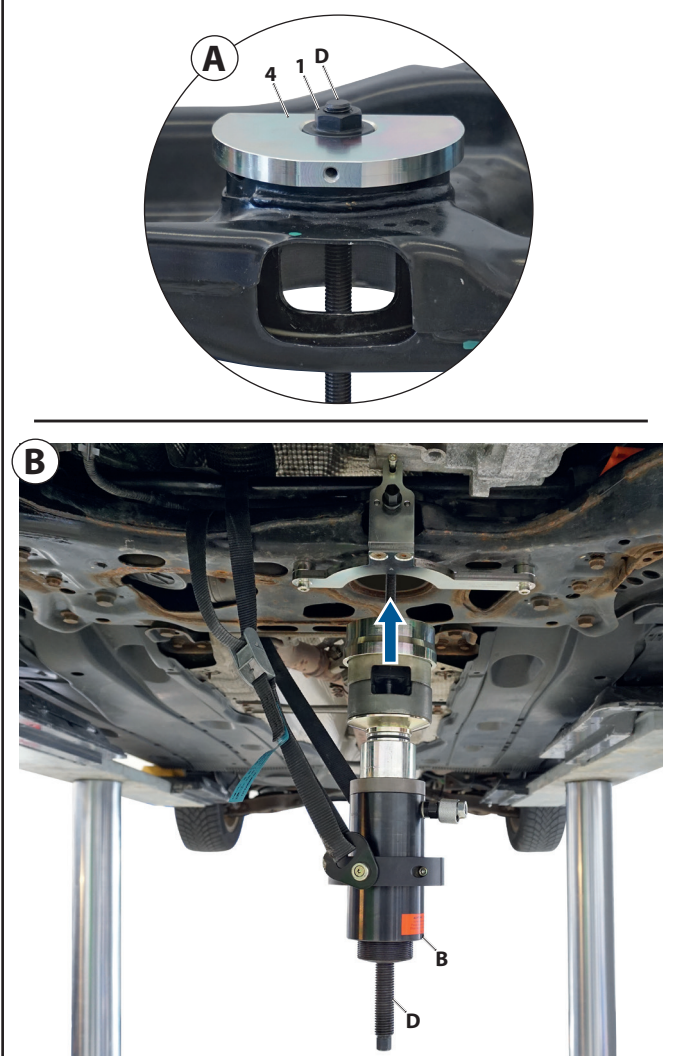

2. Clean the silent block bore on the unit support and lubricate it as well as the double silent block with a suitable assembly paste.

3. Insert the position plate "4" with the stepped side **down** at the top of the unit carrier into the double silent block hole, as shown in **Fig. 10 A**.

Then insert the draw spindle "D" from below through the double silent block (**Fig. 10 B**) until the collar nut "1" can be screwed on clockwise at the top. (**Fig. 10 A**)

**i Note:**

Screw on the collar nut "1" until the draw spindle "D" protrudes slightly at the top.

**Fig. 11:** Screw in the draw spindle "D" until the tapered sleeve "5" is in contact with the double silent block hole.

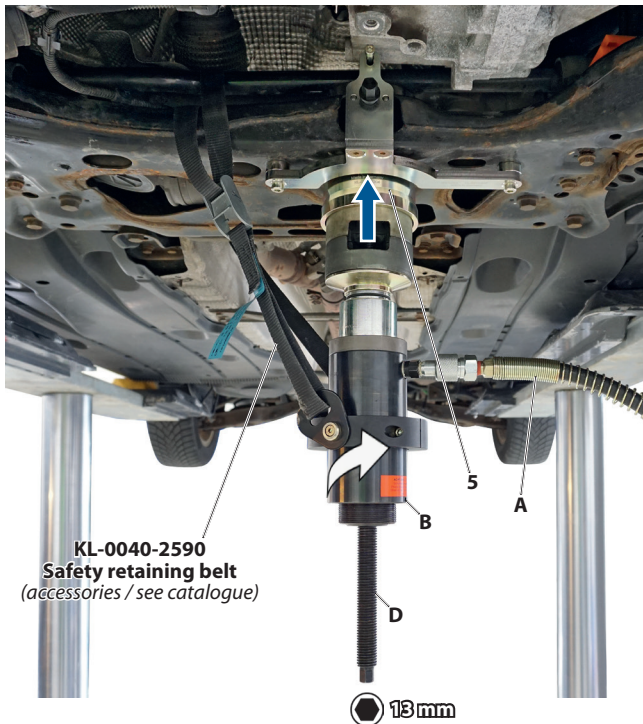

## ⚠ WARNING

The collar nut "1" may loosen, causing the double silent block tool to fall, this may result in **death or serious injury**.

- Counteract the draw spindle "D" when screwing on the hydraulic cylinder "B".

4. Screw the hydraulic cylinder "B" clockwise around the traction spindle "D" until the conical sleeve "5" rests properly against the unit carrier. (Fig. 11)

## ⓘ Note:

Counteract the draw spindle "D" via the hexagon spanner size 13mm.

## ⚠ WARNING

The double silent block tool can fall down, this may result in **death or serious injury**.

- Secure the double silent block tool against falling, for example with the safety retaining belt KL-0040-2590 or KL-0040-2592 (accessories see catalogue)

5. Secure the double silent block tool against falling, fasten the safety retaining belt - KL-0040-2590 or KL-0040-2592 to the unit carrier for this. (Fig. 11)

**Fig. 12:** Connect the preloading device "9" to the position plate "7".

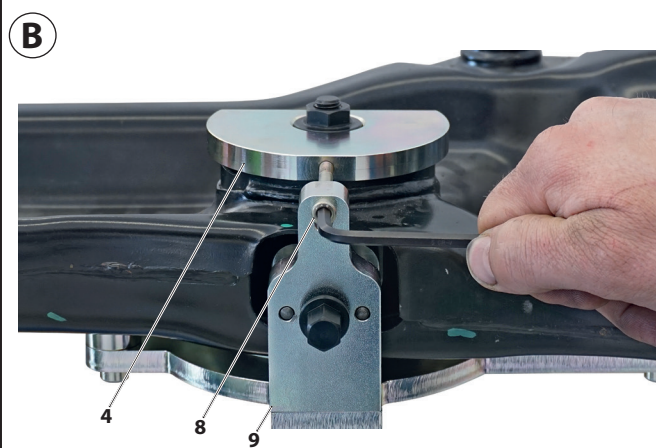
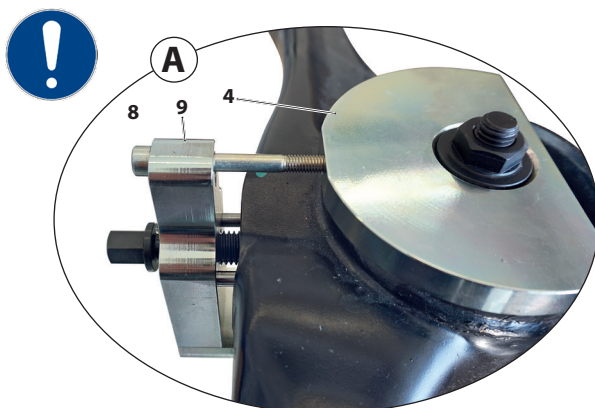

## ⚠ WARNING

Using unsuitable driving components can cause **severe or fatal injuries**.

- The double silent block tool **may only** be actuated with suitable drive components and/or hydraulic cylinder/pump combinations which ensure safe operation!

- Use **only** genuine GEDORE Automotive accessories.

6. Connect the hydraulic pump "A" to hydraulic cylinder "B". (Fig. 11)

## CAUTION

The double silent block tool and the double silent block could be damaged during the installation procedure.

- The preloading device "9" **must** be connected to the positioning plate "4" via the cap screw "8" before the installation procedure.

- Tighten cap screw "8" only until it rests lightly against the preloading device "9"; **do not** tighten any further!

7. Connect the preloading device "9" to the positioning plate "4". (Fig. 12 A)

For this, insert the cap screw "8" (width 5mm) clockwise, as shown in Fig. 12 B, until it **just** touches the preloading device "9". (**Never turn any further!**)

**Fig. 13:** Install the double silent block in the correct position, according to manufacturer's specifications.

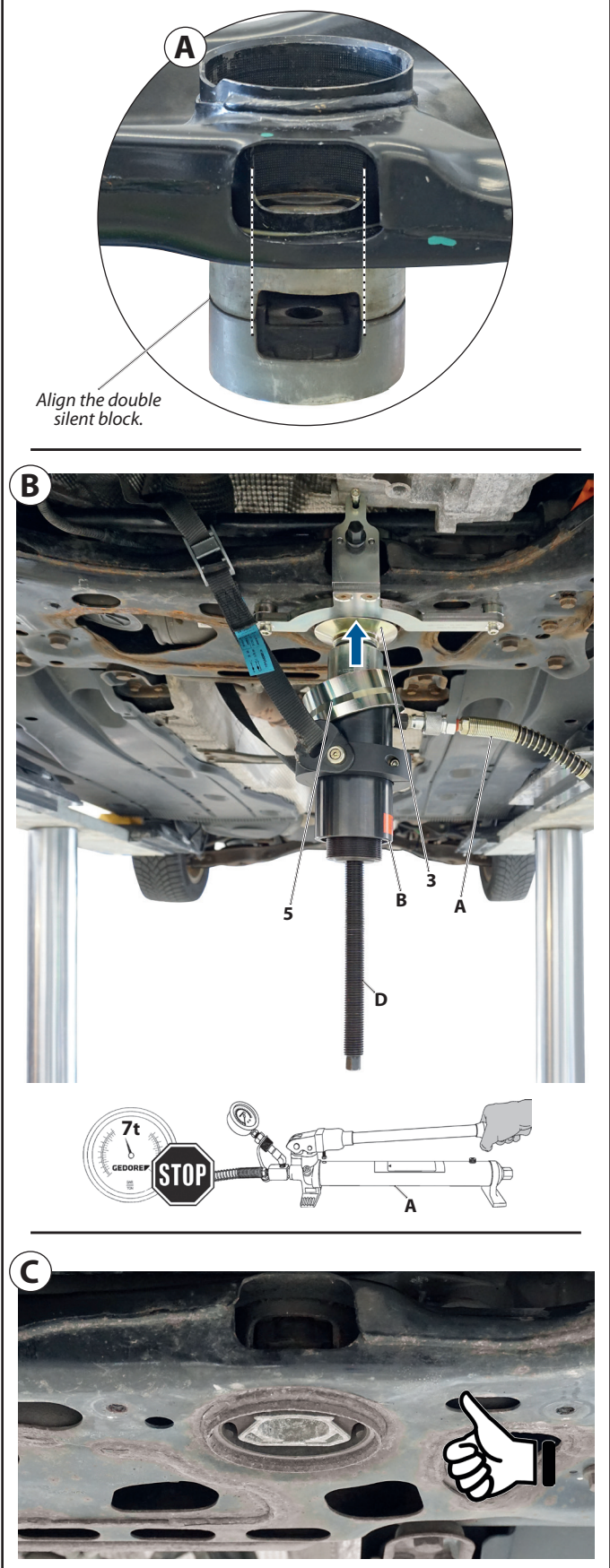

### ⚠ WARNING

During the installation of double silent blocks, there is a risk of the draw spindle "D" breaking and parts flying about. This can result in **severe or fatal injuries**.

- Do not exceed the maximum loading capacity of **7t** of the draw spindle "D"!

During the installation procedure, watch the required force on the pressure gauge of hydraulic pump "A"!

- Wear personal protective equipment (safety goggles, protective gloves, safety shoes).
- Never stand in the axial extension of the draw spindle "D".

### CAUTION

Risk of damaging the unit carrier and the double silent block during the installation.

- To prevent damage to the unit carrier and the double silent block, the preloading device "9" must be mounted and positioned before the installation.

- Align the double silent block according to the manufacturer's specifications. (Fig. 13 A)

Operate the hydraulic pump "A" and install the double silent block into the unit carrier (Fig. 13 B) until it reaches its position specified by the manufacturer. (Fig. 13 C)

### ⓘ Note:

During the installation procedure, the conical sleeve "5" on the double silent block will drop down.

The maximum stroke of the hydraulic cylinder "B" is 45mm! As soon as a high pressure builds up at the hydraulic pump "A": Interrupt the installation. Release pressure at the hydraulic pump "A", insert the draw spindle "D" until the thrust piece "3" has full contact to the double silent block again. Continue the installation procedure.



### Expert's tip:

In order to counteract a possible tilting or canting of the double silent block, hold or guide the hydraulic cylinder in a vertical position during the installation procedure.

- Relieve the hydraulic cylinder "B", dismantle the double silent block tool, and complete the vehicle according to the manufacturer's specifications.

## 5. Care and storage

**CAUTION:** Benzene and chemical solvents can damage plastic parts. After each use, clean all parts with a clean cloth only. To protect them against corrosion, lightly rub all metal parts after use with an anti-corrosion oil or wax that is suitable for tool care. Keep the special tool in a dry and clean place.

## Set of tools: KL-0214-241

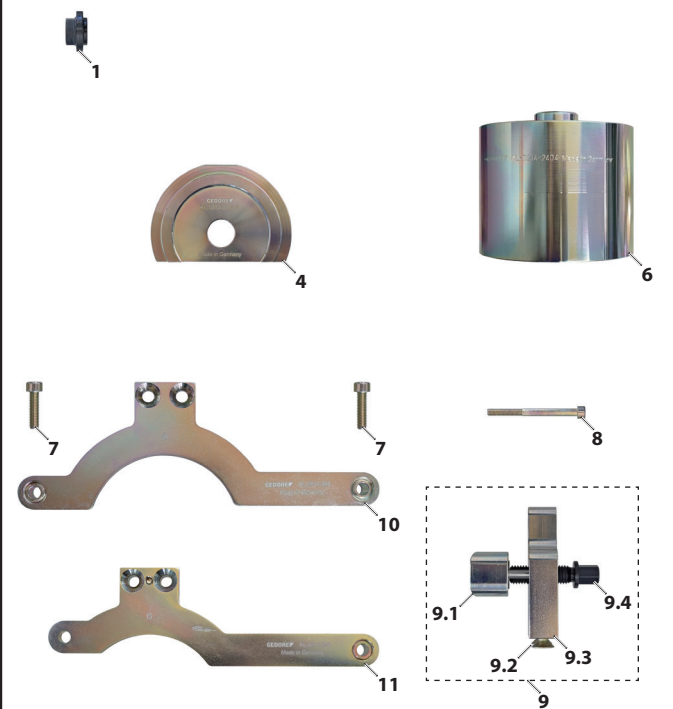

### Typical application



## 6. Maintenance and repair by the GEDORE Automotive Service Center

**WARNING:** For safety reasons, ensure that damaged special tool is no longer used. Only specifically trained personnel are allowed to carry out professional inspection and repair. Improper repair of the special tool can cause **severe** and even **fatal injuries**.

Please contact **GEDORE Automotive GmbH**  
**Breslauer Str. 41 // 78166 Donaueschingen**

**Phone: +49 (0)771/83223-71 // E-mail: info.gam@gedore.com**

## 7. Supplementary kit

### KL-0214-241 - Supplementary kit for KL-0214-220

Fits... as KL-0214-240.

The supplementary kit enables, in conjunction with the pulling device for double silent blocks **KL-0214-220** + its required drive parts, a quick and professional removal and installation of the double silent blocks (silent blocks of the torque arm) directly on the vehicle.

Item	Part no.	Description	Quantity
1	KL-0039-1912-3	Hex collar nut M12 flat	1
4	KL-0214-2203 A	Position plate	1
6	KL-0214-2404	Support sleeve diameter 98mm	1
7	KL-1283-1016	Cheese-head screw M8 x 30mm	2
8	KL-0041-7306	Cheese-head screw M6 x 70mm	1
9	KL-0214-2401	Preloading device	1
9.1	KL-0214-2401-2	Clamping shell	1
9.2	KL-5501-1432	Countersunk screw M8 x 25	2
9.3	KL-0214-2401-1	Spindle block	1
9.4	KL-0214-2401-3	Spindle	1
-	KL-0214-2401-4	Axial disc	1
-	KL-0270-3101-2	Grub screw M4 x 8	1
-	KL-0214-2401-5	Dowel pin 6 dia.x60	2
10	KL-0214-2402	Preloading plate A	1
11	KL-0214-2403	Preloading plate B	1

## 8. Environmentally compliant disposal

Dispose of the special tool and packaging material in accordance with the legal requirements in an environmentally friendly manner.



A series of horizontal lines for writing notes.

EN

## **GEDORE-Werkzeugfabrik GmbH & Co. KG**

Remscheider Straße 149  
42899 - Remscheid  
Postfach 120361  
47873 Remscheid  
GERMANY

### **Vertrieb DEUTSCHLAND**

☎ +49 (0) 2191 / 596-0  
☎ +49 (0) 2191 / 596-230  
✉ info@gedore.com  
🌐 www.gedore.com

### **Sales INTERNATIONAL**

☎ +49 (0) 2191 / 596-910  
☎ +49 (0) 2191 / 596-911  
✉ info@gedore.com  
🌐 www.gedore.com

## **GEDORE TOOLS, INC.**

Only for USA, Canada & Mexico  
Sólo para EE.UU., Canadá y México  
Seulement pour les USA, le Canada et le Mexique  
7187 Bryhawke Circle, Suite 700, North Charleston, SC 29418, USA

☎ +1-843 / 225 50 15  
☎ +1-843 / 225 50 20  
✉ info@gedoretools.com  
🌐 www.gedoretools.com

**Worldwide GEDORE service centers and offices are listed on the Internet at: [www.gedore.com](http://www.gedore.com)**

## **GEDORE Automotive GmbH**

Breslauer Straße 41  
78166 - Donaueschingen  
Postfach 1329  
78154 Donaueschingen  
GERMANY

### **Vertrieb DEUTSCHLAND**

☎ +49 (0) 771 / 8 32 23-0  
☎ +49 (0) 771 / 8 32 23-90  
✉ info.gam@gedore.com  
🌐 gedore-automotive.com



**[www.gedore-automotive.com](http://www.gedore-automotive.com)**